

Wiring Diagrams

1141D-6501

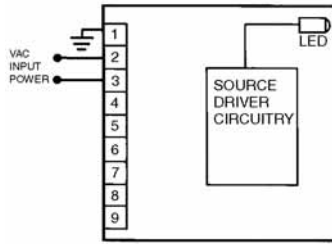

1241D-6501

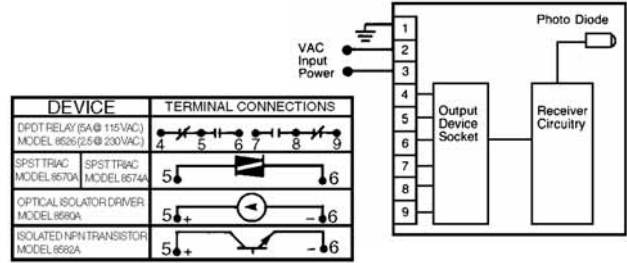

1320B-6501, 1321B-6501 and 1420B-6501

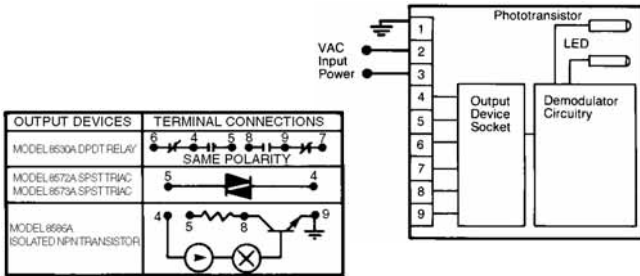

1410B-6501 and 1410B-6502

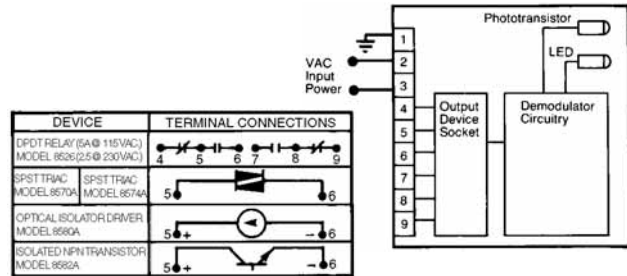

Specifications

Description	Specification
Power-On Condition	No false pulse
Temperature Range	Operating: -4° to 131°F (-20° to 55°C); Storage: -40° to 185°F (-40° to 85°C)
Material of Construction	Case: Cast aluminum; Lens: Thru-Beam — Glass, All Others — Polycarbonate
Enclosure Ratings	NEMA 3, 4, 6, 12 and 13 ①
Sunlight Immunity	10,000 foot-candles
Humidity	95% RH, non-condensing
Vibration	10g or 0.06 inch displacement, whichever is less, over 10 Hz to 1 kHz
Shock	15g minimum for 1 mS

① NOTE: Our products conform to NEMA tests as indicated, however, some severe washdown applications can exceed these NEMA test specifications. If you have questions about a specific application, contact Eaton's Cutler-Hammer Sensor Applications Department at 1-800-426-9184.

Approximate Dimensions in Inches

1141D-6501 and 1241D-6501

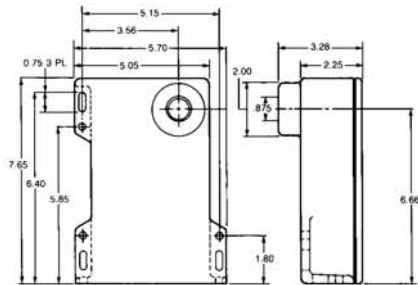

1320B-6501, 1321B-6501, 1410B-6501,
1410B-6502 and 1420B-6501

